



**CORVALLIS, OREGON**



Corvallis, Oregon  
On the campus of Oregon State University  
March 25 – 29, 2024  
Sponsorship Packet

## Introduction

The Northwest Managers of Educational Technology (NW/MET) hosts a conference in locations throughout the Northwest and Mountain West region annually in the Spring. The NW/MET 2024 Conference will be held in March of 2024 on the campus of Oregon State University in Corvallis, Oregon.

We invite you to be a sponsor of the NW/MET 2024 Conference. This will grant you an opportunity to meet with decisionmakers and interact with highly motivated and knowledgeable attendees from higher educational institutions from across the Northwest, Mountain West region, and across the country.

## Who Attends?

Educational technology touches on all aspects of an institution's core mission. At our annual conference we focus on professional development and networking as we bridge technology and pedagogy. Northwest Managers of Educational Technology members come from various professions in Higher Education:

- Classroom Technology Managers
- Computer Lab Supervisors
- Audio Visual Technicians
- Streaming and Broadcast Engineers
- Classroom Designers
- Teaching & Learning Managers
- Instructional Designers
- System and Cloud Service Administrators

## Past Attendance

PAST ATTENDANCE		
Year	Venue	Attendance
2016	Boise, Idaho	71
2017	Helena, Montana	84
2018	Corvallis, Oregon	105
2019	Las Vegas, Nevada	70
2022	Coeur d'Alene, Idaho	71
2023	Helena, Montana	88

We expect to bring well over 100 attendees to the NW/MET 2024 Conference.

## The Event

This year, the NW/MET 2024 Conference will take place over 5 days, between March 25<sup>th</sup> and March 29<sup>th</sup>, 2024. March 25<sup>th</sup> will consist of pre-conference activities. March 26<sup>th</sup> will have long-form workshops and tours of campus facilities. March 27<sup>th</sup> and 28<sup>th</sup> will consist of up to 36 traditional format 50-minute presentations or short format 10-minute lightning round presentations. These dates will also include the exhibitor showcase. March 29<sup>th</sup> will include additional facility tours and demonstrations.

## Conference Space

The NW/MET 2024 Conference will be held at the CH2M Hill Alumni Center on the campus of Oregon State University. Exhibitors will be provided an 8-foot table in the ballroom based on their sponsorship level. The table will have white linen, 2 chairs, power, and wired internet access. The venue will be locked and secure in the evenings to assure the safety of your exhibition materials.

## MET Money

It's an annual tradition. MET Money is our special fake money usable only during this conference to entice and incentivize attendees to interact with the sponsors and get engaged in the conference. Attendees then use the MET Money to buy prizes and swag at our big MET Money bash on Thursday night. Sponsors will be provided with bundles of MET Money in denominations based on their sponsorship level. You will have MET Money. Attendees will want your MET Money. They will only get MET Money if they speak to you.

## What's Included?

NW/MET prides itself in providing a welcoming and inclusive environment to all conference attendees. Conference sponsors are welcome and encouraged to participate in all sessions, events, and activities. Meals for your representatives are included in your sponsorship, as well. We only ask that the representatives of the sponsors not participate in the contests, auctions, giveaways, etc.

## Sponsorship Levels

Sponsorships will be sold on a first-come/first-served basis.

This year we are offering sponsorship tiers:

### Platinum Sponsorship – \$5,000 – 6 Available

- Sponsorship of a NW/MET event during the NW/MET 2024 Conference.
- Passes for up to 4 representatives.
- An 8-foot table in the Ballroom with white linen, 2 chairs, power, and wired internet access.
- Inclusion of your logo in NW/MET 2024 Conference marking materials.
- 100 MET Money bills in the denomination of \$20.

### Gold Sponsorship – \$2,500 – 18 Available

- Passes for up to 3 representatives.
- An 8-foot table in the Ballroom with white linen, 2 chairs, power, and wired internet access.
- Inclusion of your logo in NW/MET 2024 Conference marking materials.
- 100 MET Money bills in the denomination of \$10.

## Silver Sponsorship – \$1,000 – 7 Available

- Passes for up to 2 representatives.
- An 8-foot table in the Ballroom with white linen, 2 chairs, power, and wired internet access.
- Inclusion of your logo in NW/MET 2024 Conference marking materials.
- 100 MET Money bills in the denomination of \$5.

## Bronze Sponsorship – \$800 – 9 Available

- Pass for 1 representative.
- An 8-foot table in the South Concourse with white linen, 2 chairs, power, and wired internet access.
- Inclusion of your logo in NW/MET 2024 Conference marking materials.
- 100 MET Money bills in the denomination of \$1.

Refer to the floor plan at the end of this document for more information about the venue and table locations.

### Additional Passes

Your sponsorship level entitles you to a certain number of passes for your representatives. If you require additional passes, you may consider purchasing additional sponsorships, or you may purchase additional passes separately.

### Sessions and Workshops

Sponsors are welcome to submit sessions proposals for the conference at <https://nwmet.org/proposal/>. There will be no additional charge to the sponsor if they choose to submit a session proposal and their proposal is accepted.

### Swag

Do you have any marketing materials that you'd like distributed to attendees in your conference bag? Please contact us and let us know before shipping anything.

### Marketing and Promotion

Your sponsorship of the NW/MET 2024 Conference will be announced in the conference's physical and digital materials, including the conference website, program, email announcements, and social media posts.

## Ship In/Ship Out

Please follow the directions below if you anticipate shipping materials in advance of your arrival at the conference.

### Large or Palletized Items

Oregon State University c/o NWMET  
Freight and Hazmat Shipping  
191 S.W. 35th St.  
Corvallis, OR 97331

Your materials will be brought to the venue prior to the start of the conference.

### All Other Items

Oregon State University c/o NWMET  
725 SW 26th Street  
Corvallis, OR 97331

Pick up will be done on Friday, March 29. All your materials should be packaged on Thursday night, and ready to be shipped on Friday. Please contact your shipper to notify them that you have materials ready for pick up at the following address:

725 SW 26th Street  
Corvallis, OR 97331

You can contact carriers at:

- Airborne Express: 800-247-2676
- FedEx: 800-238-5355
- UPS: 800-742-5877

## In Kind Consideration

NW/MET often requires additional technology in order to make the conference a success. Equipment loans are also a great opportunity for a sponsor to demonstrate their devices. If NW/MET identifies specific equipment that may be required, we will reach out to you directly. In return for loaning equipment, you will receive in kind consideration in the form of a tiered promotion (e.g., a Silver Sponsor is promoted to Gold)

## Attendees List

An attendees list will not be provided to sponsors during or after the conference. But sponsor representatives will have numerous opportunities to interact with attendees during the conference and collect their contact information.

## Hotel and Travel

NW/MET has secured a special room rate for all attendees and exhibitors. To book your hotel, visit <https://nwmnet.org/hotel/>.

## Contact Information

Do you have any questions, comments, or concerns? Please reach out to us via email at [conference@nwmnet.org](mailto:conference@nwmnet.org) or you contact Raul Burriel directly at 541-737-4546.

## Venue Floor Plan

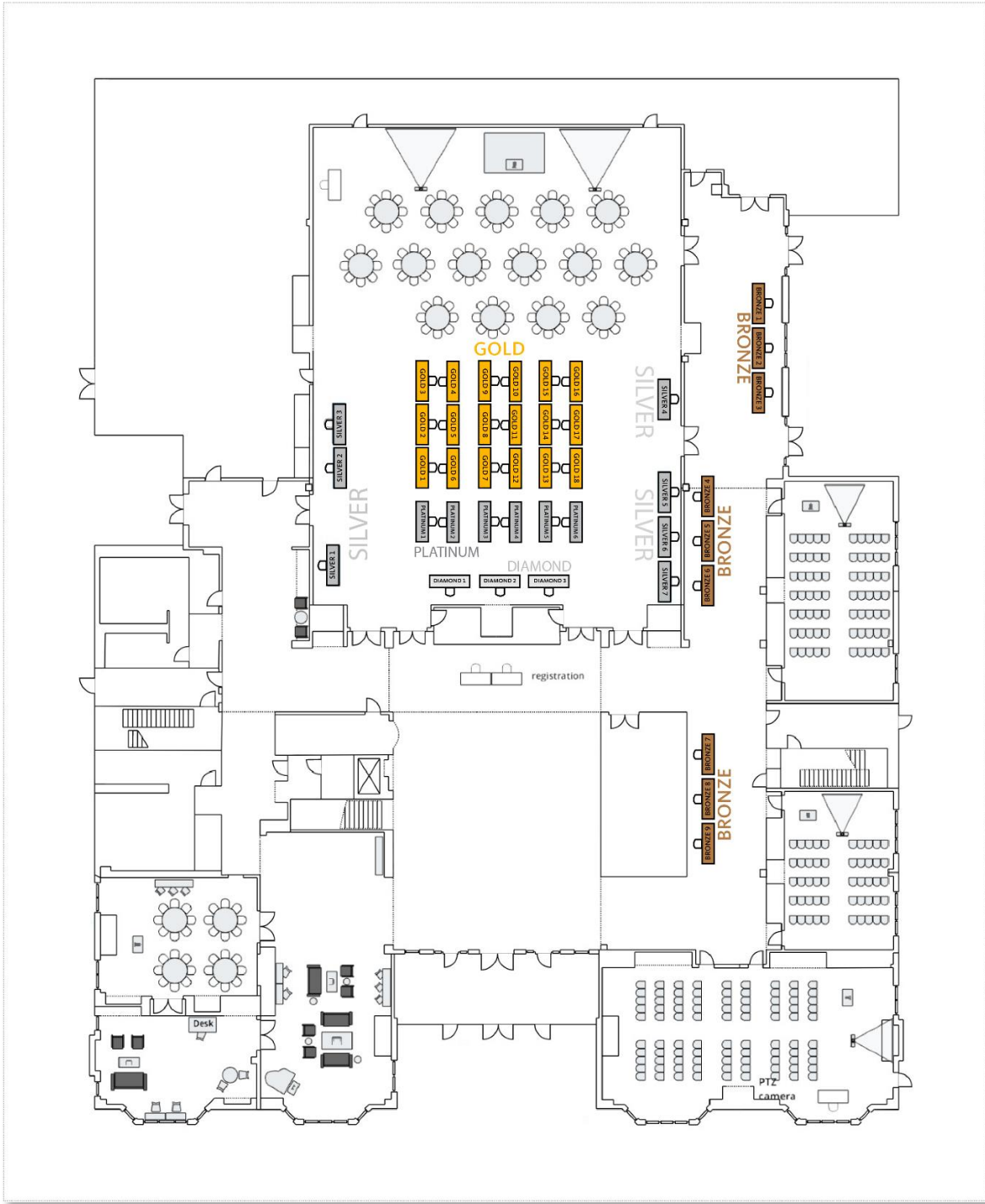

Figure 1 - CH2M Hill Alumni Center at Oregon State University

REGISTER TO BECOME A SPONSOR FOR  
THE NW/MET 2024 CONFERENCE AT  
**[NWMET.ORG/SPONSOR](https://nwmnet.org/sponsor)**